

SUPERFICIE AREA PERMEABILE-LOTTO 1

LOTTO	SUPERFICIE	AREA (MQ)
1	5,24*11,60 =	60,78
2	6,52*1,19 =	7,76
3	(7,17*1,19)/2 =	4,27
4	(5,24*2,09)/2 =	5,48
5	11,68*5,64 =	65,88
6	(21,69*11,68)/2 =	126,67
7	(25,87*3,26)/2 =	42,17
8	(2,50*10,11)/2 =	12,64
9	(4,32*10,11)/2 =	21,84
10	(5,42*6,94)/2 =	18,81
11	(5,47*7,84)/2 =	21,44
12	(2,12*6,18)/2 =	6,55
13	(3,80*6,55)/2 =	12,07
14	(1,99*5,20)/2 =	5,17
15	(2,26*18,72)/2 =	21,15
16	(2,54*18,13)/2 =	23,03
17	(2,35*2,42)/2 =	2,84
18	(2,35*2,88)/2 =	3,38
19	(12,71*3,39)/2 =	21,54
20	(2,57*12,87)/2 =	16,54
21	(18,40*12,32)/2 =	113,34
TOTALE		= 600,71

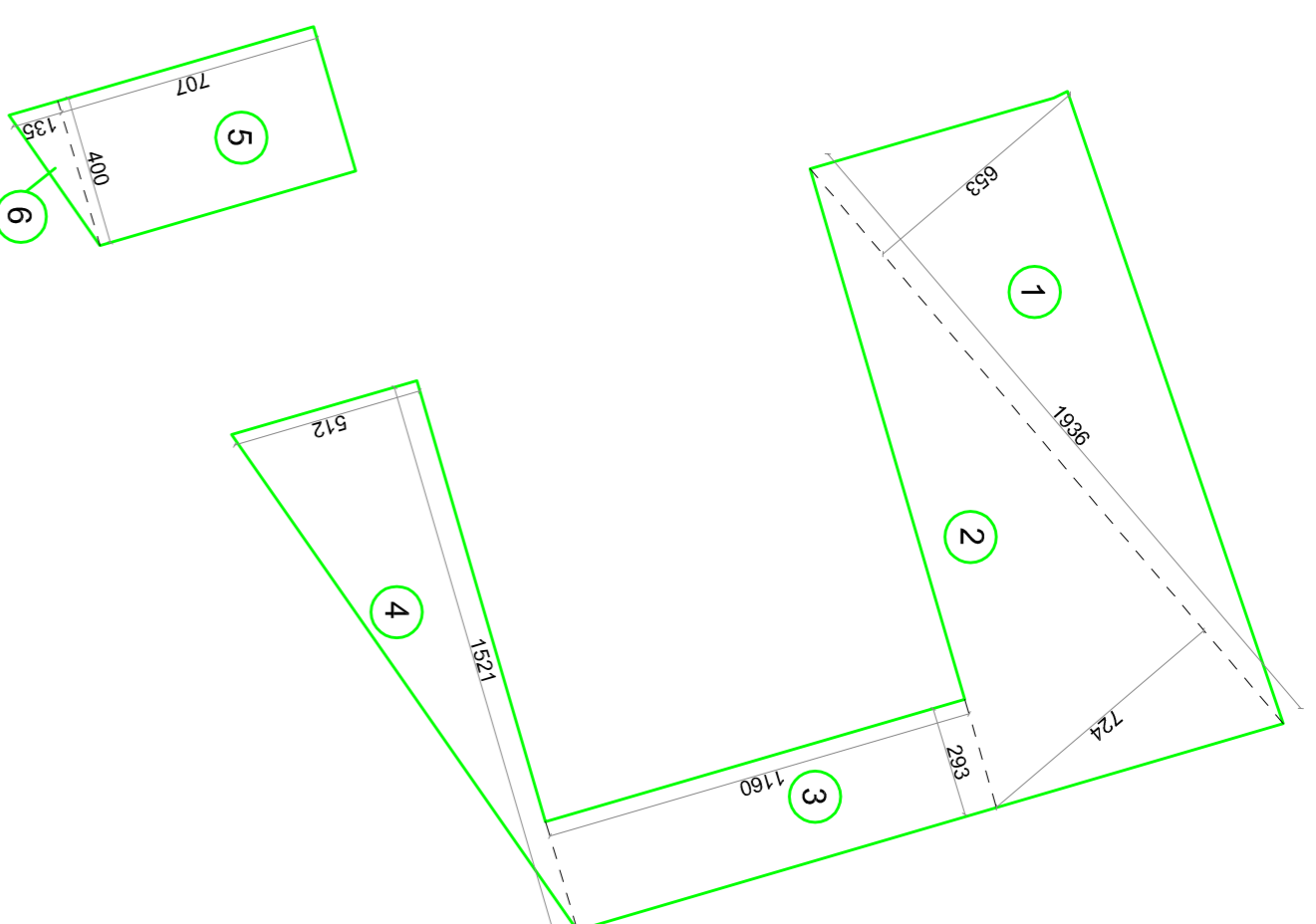

SUPERFICIE PERMEABILE-LOTTO 2

LOTTO	SUPERFICIE	AREA (MQ)
1	(6,53*19,36)/2 =	63,21
2	(7,24*19,36)/2 =	70,08
3	2,93*11,60 =	33,99
4	(5,12*15,21)/2 =	38,94
5	7,07*9 =	26,28
6	(4*1,35)/2 =	2,70
TOTALE		= 237,20

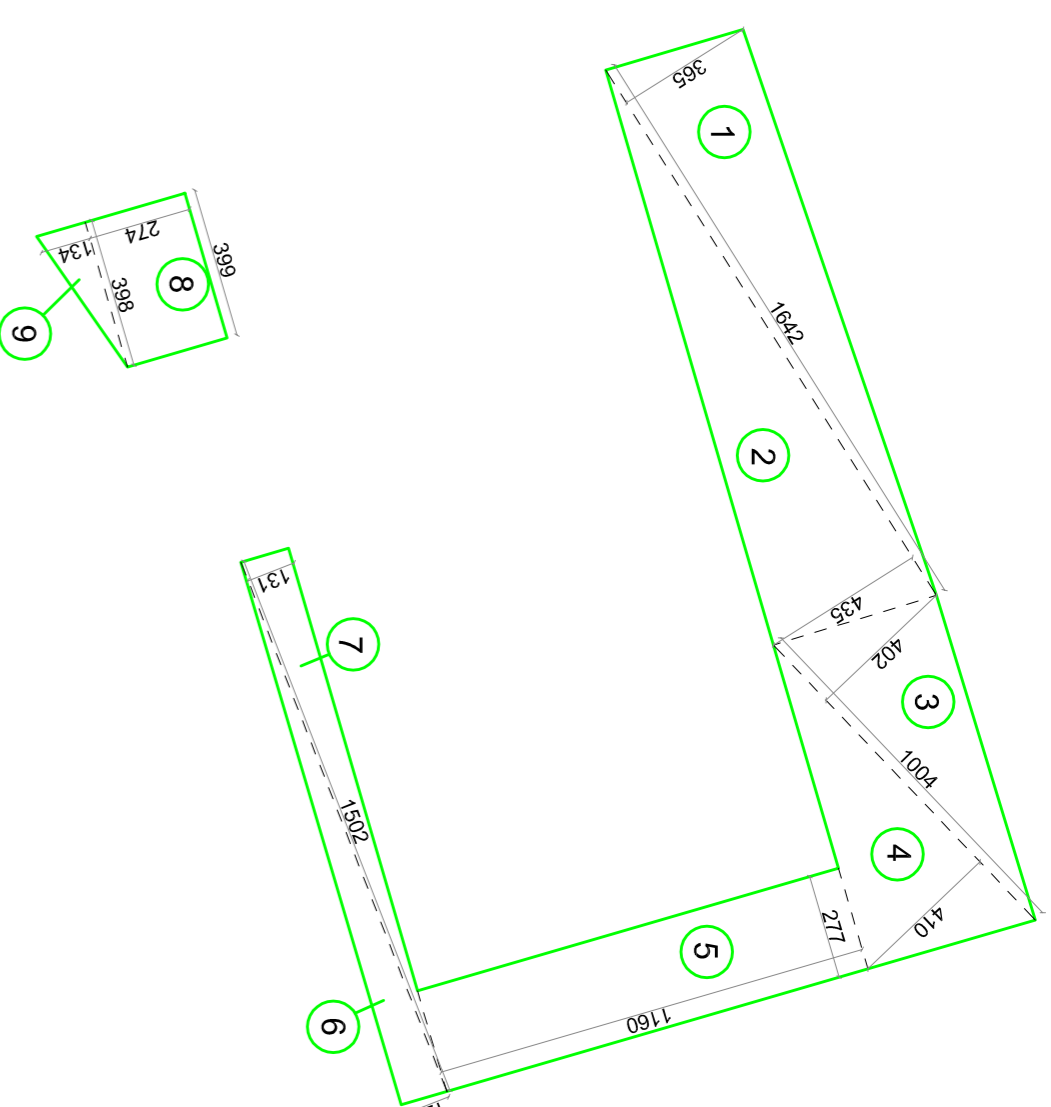

SUPERFICIE PERMEABILE-LOTTO 3

LOTTO	SUPERFICIE	AREA (MQ)
1	(3,65*16,42)/2 =	29,97
2	(4,35*16,42)/2 =	35,71
3	(4,02*10,04)/2 =	20,18
4	(4,10*10,04)/2 =	20,58
5	2,77*11,60 =	32,13
6	(1,25*15,02)/2 =	9,39
7	(1,31*15,02)/2 =	9,84
8	3,99*7,74 =	10,93
9	(1,34*3,98)/2 =	2,67
TOTALE		= 171,40

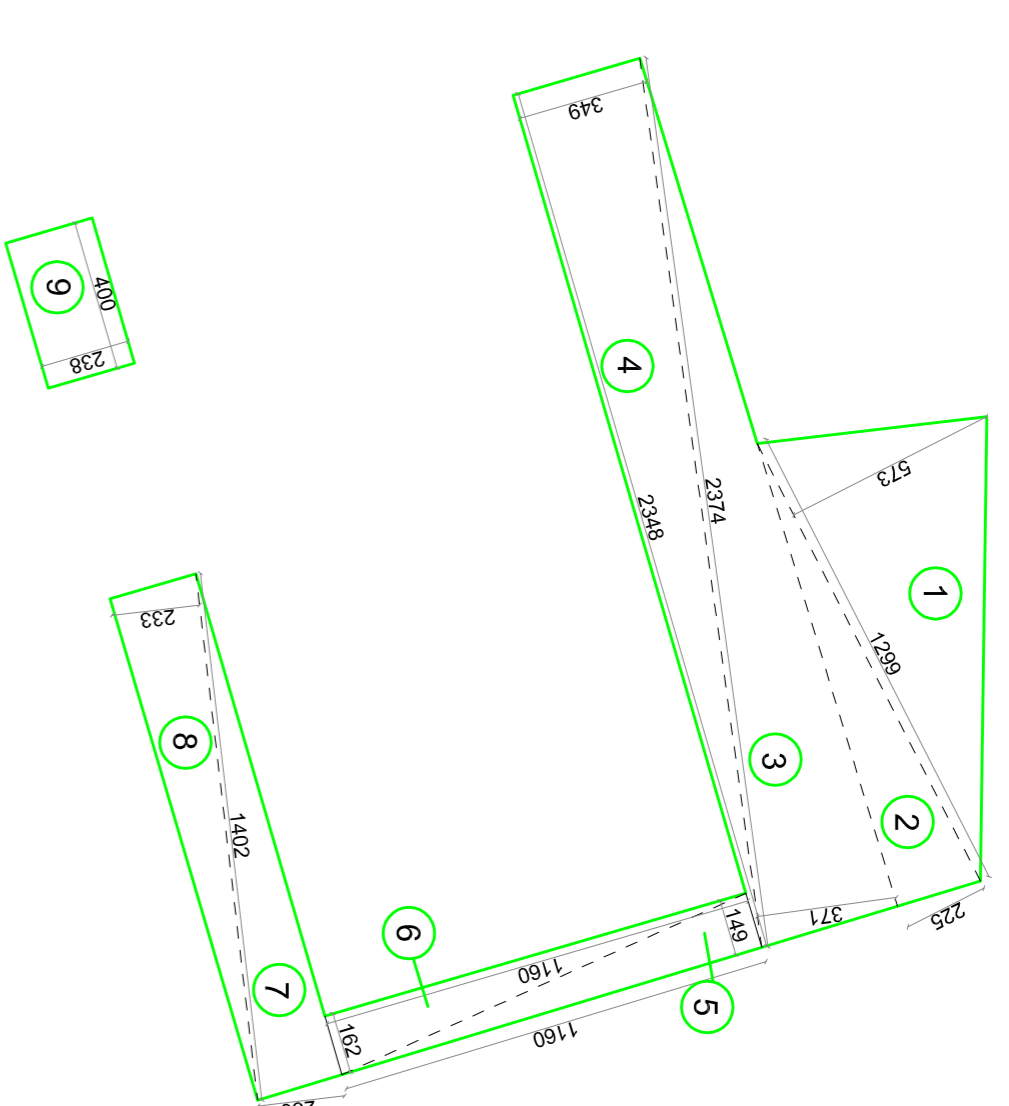

SUPERFICIE PERMEABILE-LOTTO 4

LOTTO	SUPERFICIE	AREA (MQ)
1	(5,73*12,99)/2 =	37,22
2	(2,25*12,99)/2 =	14,61
3	(3,71*23,74)/2 =	44,04
4	(3,48*23,48)/2 =	40,97
5	(1,49*11,60)/2 =	8,64
6	(1,62*11,60)/2 =	9,40
7	(2,30*14,02)/2 =	16,12
8	(2,33*14,02)/2 =	16,33
9	4*2,38 =	9,52
TOTALE		= 196,85

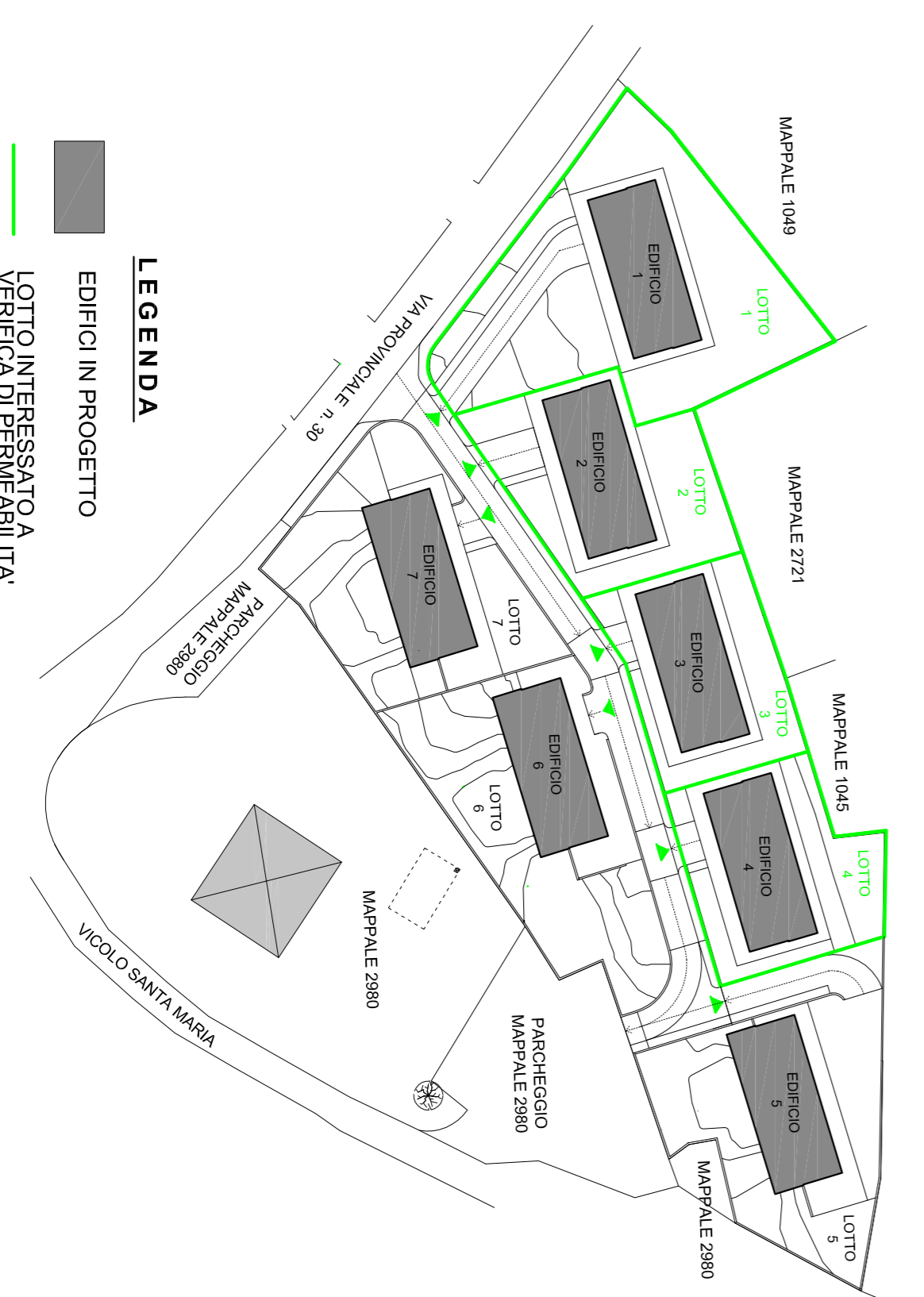

LEGENDA
 ■ EDIFICI IN PROGETTO
 ■ LOTTO INTERESSATO A VERIFICA DI PERMEABILITA'

IL TECNICO

LA PROPRIETA'

ZAPPAROLI
ARCHITETTURA

PROGETTISTA

COMMITTENTE: PAOLA GIOVANNA CAVALLERI

INTERVENTO: VIA PROVINCIALE, 30 - CADEGLIANO VICONAGO (VA)

OGGETTO: PIANO ATTUATIVO ATRS

DISEGNO: CALCOLO SUPERFICIE PERMEABILE

LOTTO 1 - 2 - 3 - 4

tel. 333 33 86 792
 arch.zapparoli@gmail.com

SCALA: 1:200

TAV. **6D**